



SLC-30



SLC-46



SLC-47

## SLC-30/46/47

- electromechanical, price competitive hour meters
- wide range of power supply
- measurement up to 999999.9 h
- high IP 65 protection class
- high shock and vibration resistance
- panel and DIN rail mounting

SLC series are highly reliable electromechanical hour meters. High shock and vibration resistance makes SLC ideal solution for monitoring maintenance of machines, production lines and equipments. They are also suitable for measuring: time between repair or wear level. SLC series is characterized by IP65 level protection and wide range of operating temperature  $-25^{\circ}\text{C} \div +80^{\circ}\text{C}$ .

### TECHNICAL DATA

	SLC-30	SLC-46	SLC-47
Power supply <u>standard:</u>	AC: 24, 230 V /50 Hz; DC: 12-36 V (SLC-30-G); AC: 230 V /50 Hz (SLC-30-D)	AC: 24, 110 /50 Hz; 230 V /50/60 Hz DC: 10-80 V	DC: 10-80 V
<u>on request:</u>	AC: 48, 60, 110, 120, 220, 240, 400 V /50 /60 Hz DC: 6-12, 36-80, 110, 220 V	AC: 48, 60, 120, 220, 240, 400 V /50/60 Hz DC: 6-30, 110, 220 V	AC: 24, 48, 60, 110, 120, 230, 240, 400 V /50 /60 Hz DC: 6-30, 110, 220 V
Voltage tolerance	$\pm 10\%$	$\pm 10\%$	$\pm 10\%$
Power consumption	AC: 8 mA max.; DC: 9 mA max.	AC: 8 mA max.; DC: 9 mA max.	AC: 8 mA max.; DC: 9 mA max.
Display	AC: 5 integers, 2 decimals; DC: 6 integers, 1 decimal; AC indicator; without reset; digit height: 4 mm	AC: 5 integers, 2 decimals; DC: 6 integers, 1 decimal; AC indicator; without reset digit height: 4 mm	AC: 5 integers, 2 decimals; DC: 6 integers, 1 decimal; AC indicator; without reset digit height: 4 mm
Protection class	IP 65 front IP 00 terminals	IP 65 front IP 00 terminals	IP 67 front IP 00 terminals
Counting range	AC: 99999,99 h; DC: 999999,9 h	AC: 99999,99 h; DC: 999999,9 h	AC: 99999,99 h; DC: 999999,9 h
Reading accuracy	AC: 1/100 h (36 sec); DC: 1/10 h (6 min)	AC: 1/100 h (36 sec); DC: 1/10 h (6 min)	AC: 1/100 h (36 sec); DC: 1/10 h (6 min)
Operating temp.	AC: $-25^{\circ}\text{C} \div +70^{\circ}\text{C}$ ; DC: $-10^{\circ}\text{C} \div +55^{\circ}\text{C}$	AC: $-25^{\circ}\text{C} \div +80^{\circ}\text{C}$ ; DC: $-20^{\circ}\text{C} \div +70^{\circ}\text{C}$	AC: $-25^{\circ}\text{C} \div +80^{\circ}\text{C}$ ; DC: $-20^{\circ}\text{C} \div +70^{\circ}\text{C}$
Storage temp.	AC: $-40^{\circ}\text{C} \div +70^{\circ}\text{C}$ ; DC: $-20^{\circ}\text{C} \div +70^{\circ}\text{C}$	AC: $-40^{\circ}\text{C} \div +80^{\circ}\text{C}$ ; DC: $-20^{\circ}\text{C} \div +70^{\circ}\text{C}$	AC: $-40^{\circ}\text{C} \div +80^{\circ}\text{C}$ ; DC: $-20^{\circ}\text{C} \div +70^{\circ}\text{C}$
Relative humidity	80% max. @ $+25^{\circ}\text{C}$	80% max. @ $+25^{\circ}\text{C}$	80% max. @ $+25^{\circ}\text{C}$
Mounting	SLC-30-G: panel SLC-30-D: DIN rail	SLC-46-G: panel SLC-46-G + SLC-46 DIN: DIN rail	SLC-47-A: panel SLC-47-C: panel with anti-vibration boot&clamp
Dimensions (WxHxD)	case: 36 x 24 x 51 mm (SLC-30-G); 35 x 85 x 55 mm (SLC-30-D) panel cut-out: 33 x 22 mm (SLC-30-G)	case: 48 x 48 x 38 mm panel cut-out: 46 x 46 mm lub $\varnothing 51$ mm	case: $\varnothing 58$ mm (SLC-47-A); $\varnothing 80$ mm (SLC-47-C) panel cut-out: $\varnothing 51$ mm (SLC-47-A), $\varnothing 72$ mm (SLC-47-C)
Weight	ca. 30 g	ca. 50 g	ca. 50 g (SLC-47-A); ca. 60 g (SLC-47-C)
Accessories	SLC-30 R48 - mounting bezel 48 x 24 mm	SLC-46 R55 - mounting bezel 55 x 55 mm SLC-46 R72 - mounting bezel 72 x 72 mm SLC-46 DIN - DIN rail mounting	



**DIMENSIONS**

SLC-30-G

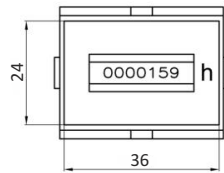

Case dimensions

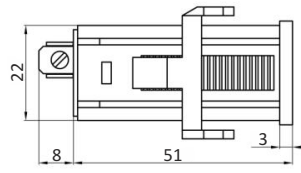

Side view

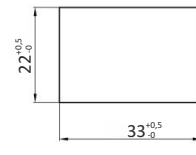

Panel cut-out

SLC-30-D

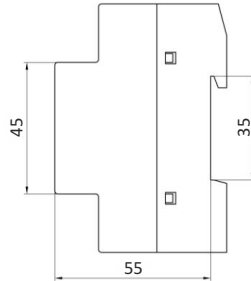

Side view

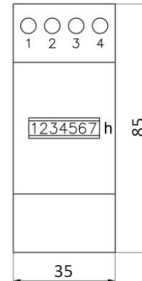

Case dimensions

SLC-46-G

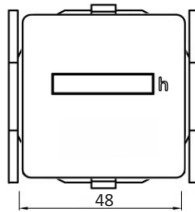

Front view

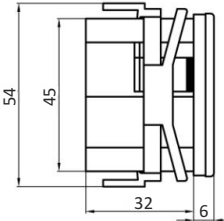

Side view

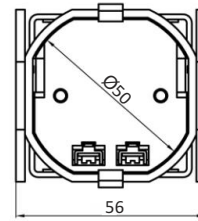

Rear view

SLC-47-A

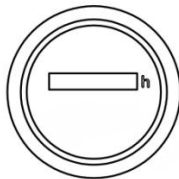

Front view

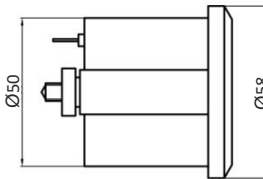

Side view

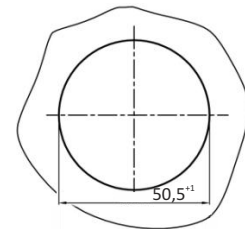

Panel cut-out

SLC-47-C

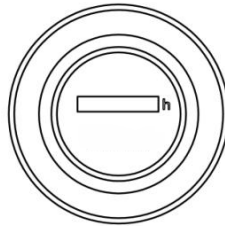

Front view

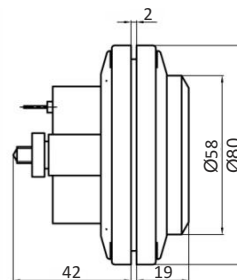

Side view

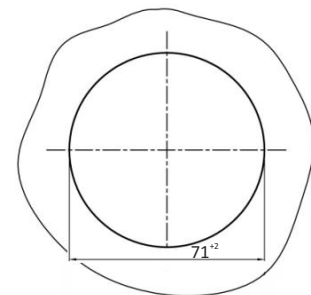

Panel cut-out

**ORDERING**

SLC-X-X-X-X-001

version:

- 30
- 46
- 47

frequency (for AC version)

power supply

mounting options:

- A : panel (only for SLC-47)
- C : panel, anti-vibration boot & clamp Ø80 mm (only for SLC-47)
- G : panel (only for SLC-30 and SLC-46)
- D : DIN rail TS-35 (only for SLC-30)

Ordering examples:

- SLC-30-G-12-36VDC-001
- SLC-46-G-230VAC-50Hz-001
- SLC-47-C-10-80VDC-001

